

AREA CALCULATIONS:

FIRST FLOOR A/C = 1 242 SF
 FIRST FLOOR GARAGE = 1 610 SF
 FIRST FLOOR DECKS = 2 642 SF
 TOTALS = 5 494 SF

SECOND FLOOR A/C = 5 121 SF
 SECOND FLOOR DECKS = 2 816 SF
 TOTALS = 7 937 SF

THIRD FLOOR A/C = 2 620 SF
 THIRD FLOOR DECKS = 2 020 SF
 TOTALS = 4 640 SF

OVERALL A/C = 8 983 SF
 OVERALL DECKS = 7 478 SF

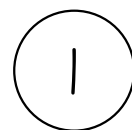

FIRST FLOOR

SCALE: 1/16" = 1'-0"

SPAIN RESIDENCE 2105 NORTH TROPICAL TRAIL MERRIT ISLAND, FL 32953

© copyright 2016 - this drawing and its reproductions are the property of the architects, spacecoast architects, p.a., and may not be reproduced, published, modified, or used in any way without written permission by the architects.

#1512 - 02.09.16

SPACECOAST ARCHITECTS, P.A.

333A FIFTH AVENUE
 INDIALANTIC, FL 32903
 PHONE (321)728-4422
 FAX (321)728-0076
 EMAIL larry-spacearc@cfl.rr.com



FL REG AA C1890

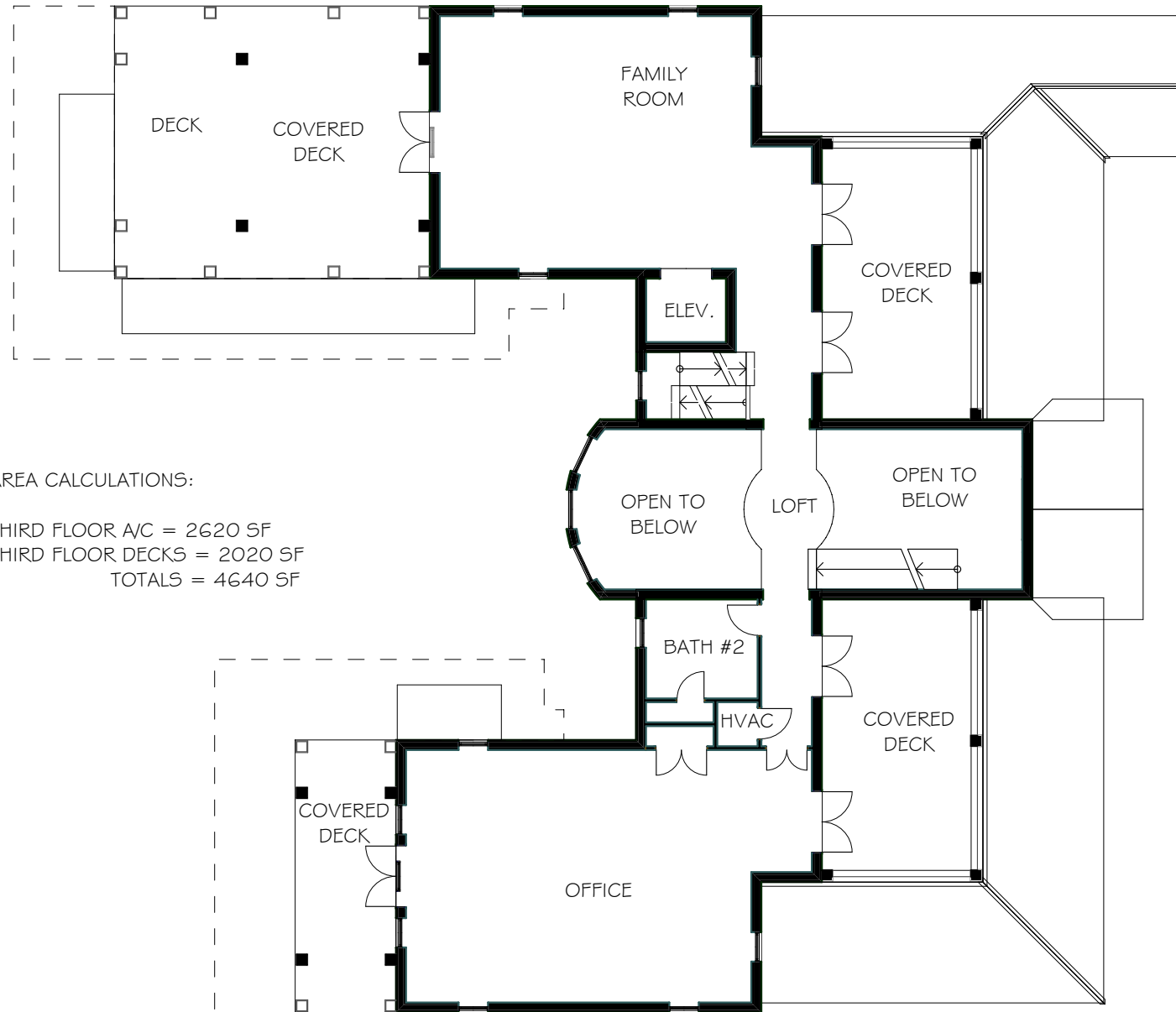

AREA CALCULATIONS:
 THIRD FLOOR A/C = 2620 SF
 THIRD FLOOR DECKS = 2020 SF
 TOTALS = 4640 SF

2 THIRD FLOOR
 SCALE: 1/16" = 1'-0"

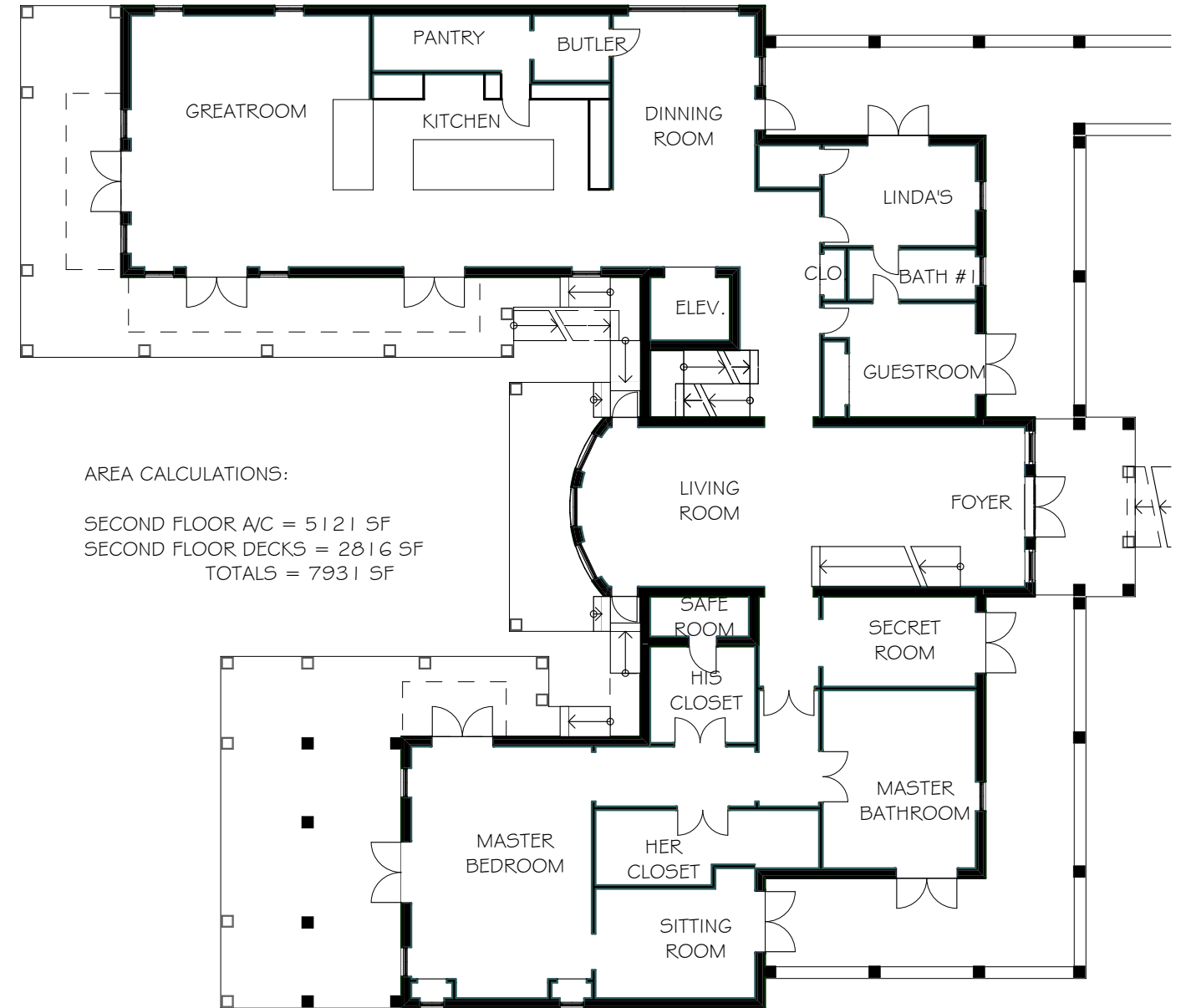

AREA CALCULATIONS:
 SECOND FLOOR A/C = 5121 SF
 SECOND FLOOR DECKS = 2816 SF
 TOTALS = 7937 SF

1 SECOND FLOOR
 SCALE: 1/16" = 1'-0"



CONCEPT RENDERING

SPAIN RESIDENCE 2105 NORTH TROPICAL TRAIL MERRIT ISLAND, FL 32953

© copyright 2016 - this drawing and its reproductions are the property of the architects, spacecoast architects, p.a., and may not be reproduced, published, modified, or used in any way without written permission by the architects.

#1512 - 02.09.16

SPACECOAST ARCHITECTS, P.A.

333A FIFTH AVENUE
INDIALANTIC, FL 32903
PHONE (321)728-4422
FAX (321)728-0076
EMAIL larry-spacearc@cfl.rr.com



FL REG AA C1890



CONCEPT RENDERING

SPAIN RESIDENCE 2105 NORTH TROPICAL TRAIL MERRIT ISLAND, FL 32953

© copyright 2016 - this drawing and its reproductions are the property of the architects, spacecoast architects, p.a., and may not be reproduced, published, modified, or used in any way without written permission by the architects.

#1512 - 02.09.16

SPACECOAST ARCHITECTS, P.A.

333A FIFTH AVENUE
INDIALANTIC, FL 32903
PHONE (321)728-4422
FAX (321)728-0076
EMAIL larry-spacearc@cfl.rr.com



FL REG AA C1890